



ORIGINAL INSTRUCTIONS

CAUTION – READ THESE INSTRUCTIONS BEFORE USING THE MACHINE

i-scrub 21B
Commercial Floor Cleaning Machine

USER MANUAL

EN



www.truvox.com

EC DECLARATION OF CONFORMITY

EN (English)

Machine Type: Floor cleaning machine

Model: ISCRUB...



This machine is in conformity with the following EU directives:

- Machinery Directive: 2006/42/EC
- The EMC Directive: 2014/30/EU

Applied harmonised standards:

BS/EN60335-1, BS/EN60335-2-10, BS/EN55014-1, BS/EN55014-2, BS/EN61000-3-2, BS/EN61000-3-3, BS/EN62233,

M. Eneas.

Truvox International Limited, Unit C (East), Hamilton Business Park, Manaton Way
Botley Road, Hedge End, Southampton, SO30 2JR, UK

Malcolm Eneas, Operations Director
16/10/2024

EC DECLARATION OF CONFORMITY

EN (English)

Machine Type: Floor cleaning machine

Model: ISCRUB...



This machine is in conformity with the following EU directives:

- Machinery Directive: 2006/42/EC
- The EMC Directive: 2014/30/EU

Applied harmonised standards:

EN60335-1, BS/EN60335-2-10, EN55014-1, BS/EN55014-2, EN61000-3-2, EN61000-3-3, EN62233,

M. Eneas.

Truvox International SARL, 38 rue de Berri
75008 Paris, France

Malcolm Eneas, Operations Director
16/10/2024

IMPORTANT - BEFORE USE READ THESE INSTRUCTIONS AND RETAIN FOR FUTURE REFERENCE**INTRODUCTION**

The following instructions contain important information about the machine and safety advice for the operator. Equipment must be operated, serviced, and maintained in accordance with the manufacturer's instructions. If in doubt, contact the supplier of your machine.



Read all instructions before using the machine

PRODUCT INFORMATION

The i-scrub 21B floor cleaning machine is designed for use on smooth, even floors in indoor areas. This machine is for indoor use only. The machine is intended for commercial use, for example in hotels, schools, hospitals, factories, shops, offices, rental businesses and other than normal housekeeping purposes.

BATTERY INFORMATION

The batteries must be fully charged before use.

SAFE DISPOSAL OF BATTERIES

- The batteries must be neutralised through an approved secondary treatment facility prior to disposal as waste.
- The battery can be recycled at an authorised facility, through a licensed waste carrier.

DETERGENTS AND CHEMICALS

1. When using cleaning and care agents, the manufacturer's danger warnings must be followed and protective goggles and clothing must be worn.
2. Only use low-foaming, water based, non-combustible cleaning agents which do not contain generally health-hazardous substances.
3. Please ensure that after each use any chemical residue is rinsed out with clean water.
4. DO NOT use cleaning solutions with a pH Level below 3 or above 11 in order to prevent damage to sensitive components.

TECHNICAL SPECIFICATIONS

Model	Iscrub 21B	
Product Code	ISCRUB	
Charging Voltage AC (~)/ Frequency	V/Hz	110-240/ 50/60
Battery voltage D.C	V	12
Battery details	Ah	6.6
Run time	mins	150
Charge time	mins	210
Motor power	W	25
Brush speed	rpm	400
Sound pressure level	dB (A)	73
Solution tank capacity	litres	2
Dimensions (L x W x H)	cm	15 x 25 x 915-1270
Weight (inc. Battery)	kg	4.2
Warranty	1 year subject to conditions	

- Handle vibration does not exceed 2.5 m/s² when operating on a smooth hard surface.
- Noise levels measured at a distance of 1 meter from machine and 1.6 metres above floor, when washing a hard floor. Measurements recorded using a hand held meter.
- Above dimensions are approx. Since the company's policy is to continuously improve the product, there could be changes without prior notice.

WASTE ELECTRICAL & ELECTRONIC EQUIPMENT (WEEE)

Do not dispose of this device with unsorted waste. Improper disposal may be harmful to the environment and human health. Please refer to your local waste authority for information on return and collection systems in your area.

IMPORTANT SAFETY ADVICE

The safety information described in this manual provides basic precautions and supplements standards in force in the country where the machine is used.



This symbol warns the operator of hazards and unsafe practices which could result in severe personal injury or death.



WARNING – to reduce the risk of injury, electric shock or fire.

1. This machine must only be used for the manufacturer's approved application as described in this manual.
2. The machine must be unpacked and assembled in accordance with these instructions before connecting to the electrical supply.
3. Only genuine accessories and spare parts provided with the machine or those approved by the manufacturer should be used. The use of other accessories may impair the safety of the machine. All repairs must be performed by a qualified service agent.
4. **DO NOT** modify the machine from its original design.
5. Operators must be fully trained in the use of the machine in accordance with these instructions, able to perform regular user maintenance and the correct selection of accessories.
6. Operators should be physically capable to manoeuvre, transport and operate the machine.
7. Operators should be able to recognise unusual operation of the machine and report any problems.
8. This machine is not intended for use by persons (including children) with reduced physical, sensory or mental capabilities, or lack of experience and knowledge, unless they have been given supervision or instruction concerning use of the machine by a person responsible for their safety.
9. Keep children and unauthorised persons away from the machine when in use. **DO NOT** use as a toy.
10. **DO NOT** use if it has been damaged, left outdoors or dropped in water.
11. **DO NOT** use where hazardous dust is present.
12. **DO NOT** use in an explosive atmosphere.
13. **DO NOT** pick up or use near flammable or combustible fluids, hazardous dusts or vapours.
14. **CAUTION** - If it is suspected that there is hazardous dust or flammable/corrosive material, stop cleaning the area immediately and consult your superior.
15. **DO NOT** use to clean up any burning or lighted materials such as cigarettes, matches, ashes or other combustible objects.
16. Only use the machine on firm level surfaces. **DO NOT** use on a gradient or slope of more than 2%.
17. **DO NOT** use on rough, uneven surfaces e.g., industrial, or coarse concrete surfaces.
18. **DO NOT** use outdoors e.g., on patios, decks or rough surfaces.
19. **CAUTION** - This machine is for dry indoor use only and should not be used or stored outdoors in wet conditions.
20. Take care when using a machine near the top of stairs to avoid overbalancing.
21. **DO NOT** cover the machine when in use.
22. **DO NOT** run the machine dry, as this could damage the floor surface or the machine itself.
23. **DO NOT** leave machine running unattended.
24. Keep hair, loose clothing, hands, feet and all other parts of the body away from openings and moving parts.
25. **DO NOT** put any object into openings. **DO NOT** use with any opening blocked; keep free of dust, debris and anything that may reduce airflow.
26. **DO NOT** use volatile or combustible solvents (e.g., diesel/petrol/IPA/trichloromethane) nor any corrosive, toxic or highly irritant substances to wash floors, even if diluted. In the event of accidental contact with any such substances (e.g., due to spills) follow the decontamination procedures in force at the user site. If in any doubt about the condition of the machine, contact Truvox or the dealer/agent who supplied the machine.
27. **DO NOT** operate the machine if it malfunctions or is damaged in any way. Contact an authorised service agent for repair or adjustments.
28. **WARNING DO NOT** fill the machine with water hotter than 40°C.



CAUTION - Risk of electric shock

29. **DO NOT** operate the machine with a damaged power cord or plug, or after the machine malfunctions or is damaged in any way. Contact an authorised Service Agent for repair or adjustment.
30. The machine must be kept clean and in good condition with regular inspections of the power cord and plug for signs of any damage. If any parts are damaged, they shall only be replaced by an approved part by the manufacturer, its service agent or a similar qualified person in order to avoid a hazard.
31. Only replace the charger power cord with the type specified in the instruction manual
32. When unplugging, pull the plug, not the power cord.
33. **WARNING:** Keep the power cord clear of moving parts.
34. **DO NOT** kink or twist the power cord and keep cord away from heated surfaces.
35. Unless charging, the plug of the charger power cord must be removed from the socket-outlet when not in use and before commencing cleaning of the machine or undertaking maintenance operations.
36. Opportunity / top up charging may damage the batteries. This may cause the run time to fall and overall battery life to be affected. AVOID TOP UP CHARGING.
37. **WARNING** – Charge only in a well-ventilated area.
38. **WARNING** - If the appliance is to be stored unused for a long period of time, disconnect the batteries.
39. **WARNING** - Do not short-circuit the supply terminals.
40. Report any liquid leaking from the battery. Leaks are dangerous and highly polluting.
41. The machine shall be disconnected from its power source when not in use and before commencing cleaning of the machine or maintenance and when replacing parts or accessories, by removing the plug from the socket-outlet.

OPERATION

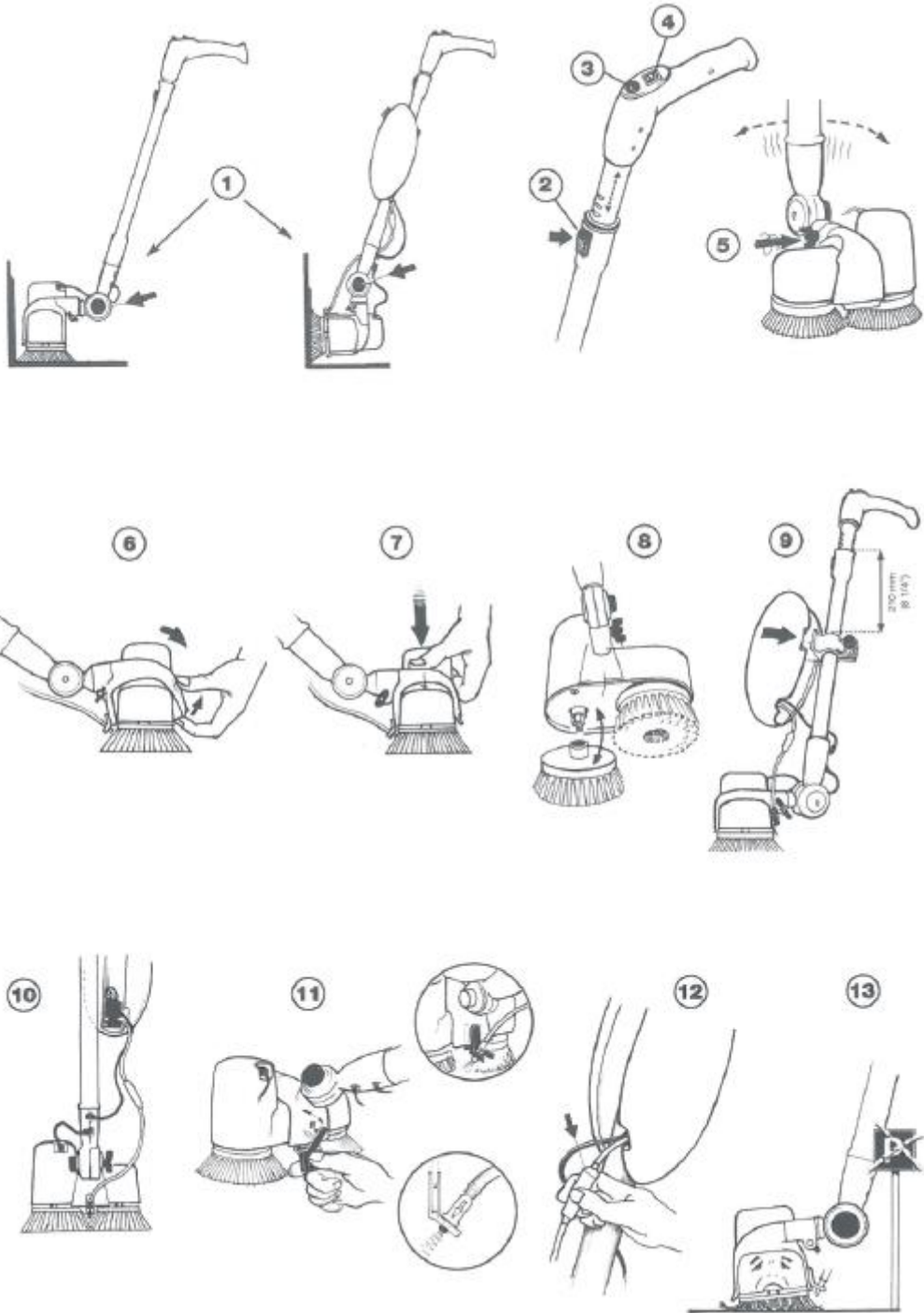

1. Button for adjusting and setting the angle of the base.
2. Button for adjusting and setting the handle length.
3. Push-button for switching the pump on/off.
4. On/off switch for iscrub
5. Screw for adjusting the angle of the brush head
6. To remove the scrubber head lift the front edge of the holder and twist the scrubber head forwards
7. To fit the scrubber head: press the holder into place. Check that the hooks have engaged properly under the cover.
8. To attach and remove the brushes and disc holder, push on or pull off accordingly. When re-attaching ensure the hexagonal locators are aligned on both the brush and head and click into position.
9. To fit the solution tank, fit the holder into the handle with the solution tank opening at the top. Press the tank into position. Ensure the cable or hose is not trapped.
10. Ensure the hose and cable is connected
11. Fitting/removing the nozzle holder. The nozzle and hose will need to be removed when removing the tank only.
12. Priming bag for pump. If no detergent comes out when the pump starts, squeeze the bag once.
13. Do not store the machine with the brushes and discs on.

TRANSPORTING THE MACHINE

- Incorrect lifting techniques may result in personal injury. We advise that the manual handling regulations are followed.
- Ensure the machine is empty and remove the battery.
- Do not expose the machine to rain or moisture.
- When transporting the machine ensure that all components, tanks and removable parts are securely fastened, and that the power cord and plug are not trailing.
- Do not lift or transport the machine whilst containing liquid as this will add considerably to the weight.

STORAGE

- Always switch off, empty, wipe down and dry the machine after use.
- Both the solution and recovery tanks should be emptied and flushed out with clean water
- Store the machine in a dry indoor area only.
- Remove the brushes and discs for storage. If kept on they may lose their shape, if this occurs, soak brushes in warm water to restore.

MAINTENANCE

 **WARNING** - Before undertaking maintenance operations or adjustments switch off machine and remove the battery.

 **IMPORTANT** - All other servicing and repairs should only be performed by a Truvox engineer or Authorised Service Agent.

IMPORTANT - Should the machine fail to operate please refer to the fault diagnosis section in the back of this instruction manual. If the problem / remedy is not listed, please contact Truvox Customer Service Department for rapid attention.

The machine requires minimum maintenance apart from the following checks by the operator prior to use:

- Body of the machine - Clean with a damp cloth.
- Charger power cord - regularly inspect sheath, plug and cord anchorage for damage or loose connection. Only replace the power cord with the type specified in these instructions.
- Brushes - Check to see if both brushes are clean and intact. Clean them under fresh water or replace them if necessary.

AFTER SALES SERVICE

Truvox machines are high quality machines that have been tested for safety by authorised technicians. It is always apparent that after longer working periods, electrical and mechanical components will show signs of wear and tear or ageing. To maintain operational safety and reliability the following service interval has been defined: Every year or after 250 hours. Under extreme or specialised conditions and/or insufficient maintenance, shorter maintenance intervals are necessary.

Use only original Truvox spare parts. Use of other spare parts will invalidate all warranty and liability claims. Should you require after sales service please contact the supplier from whom you purchased the machine, who will arrange service. Repairs and servicing of Truvox products should only be performed by trained staff. Improper repairs can cause considerable danger to the user.

GUARANTEE

Your product is guaranteed for one year from the date of original purchase, or hire purchase, against defects in materials or workmanship during manufacture. Within the guarantee period we undertake at our discretion, to repair or replace free of charge to the purchaser, any part found to be defective, subject to the following conditions:

CONDITIONS

1. Claims made under the terms of the guarantee must be supported by the original invoice/bill of sale issued at the time of sale, or the machine Serial No.
2. For claims under this guarantee contact the supplier from whom you purchased the product who will arrange the appropriate action. Do not initially return the product as this could result in transit damage.
3. Neither Truvox nor its distributor shall be liable for any incidental or consequential loss.
4. This guarantee is governed by the laws of England.
5. This guarantee does not cover any of the following:
 - Periodic maintenance, and repair or replacement of parts due to normal wear and tear.
 - Damage caused by accident, misuse or neglect, or the fitting of other than genuine Truvox parts.
 - Defects in other than genuine Truvox parts, or repairs, modifications or adjustments performed by other than Truvox service engineer or authorised service agent.
 - Costs and risks of transport relating directly or indirectly to the guarantee of this product.
 - Consumable items such as, brushes, drive discs, filters and vacuum skirts.

This guarantee does not affect your statutory rights, or your rights against the supplier arising from their sales or purchase contract. Truvox International Limited policy is one of continual product development and we reserve the right to alter specifications without prior notice.

RECOMMENDED SPARES & ACCESSORIES

Description

i-scrub Pad Mixed 10cm (10pcs)	86-0017-0000
i-scrub Pad Red 10cm (10pcs)	86-0018-0000
i-scrub Blue Mixed 10cm (10pcs)	86-0019-0000
i-scrub Battery Pack (without case)	86-0020-0000

FAULT DIAGNOSIS

The following simple checks may be performed by the operator. If the machine is still not working, please contact your local Service Agent:

Trouble	Reason	Remedy
Machine fails to start – no power	<ul style="list-style-type: none">• Battery not connected• Low battery	<ul style="list-style-type: none">• Connect battery• Charge battery
Uninsufficient/no water flow	<ul style="list-style-type: none">• Empty tank• Damaged water pipe• Blocked water pipe	<ul style="list-style-type: none">• Fill the tank• Replace water pipe• Squeeze pipe to release blockage
Battery not charging	<ul style="list-style-type: none">• Battery has reached end of life	<ul style="list-style-type: none">• Replace battery
Charger not charging		<ul style="list-style-type: none">• Contact service agent

*If the fuse blows several times, the machine should be checked by an authorised Service Agent